



## Constant Vacuum Pump

- Simple integration in any set-up
- Ideal for use with perforated microelectrode arrays
- User-friendly handling
- Precise control of suction



## Precise control of suction

The constant vacuum pump (CVP) with pressure control is a vacuum pump with a precision pressure sensor and a waste bottle.

The differential sensor measures the pressure in the compartment attached to the waste bottle, and compares it to the ambient pressure. The suction pump is then regulated to maintain the selected negative pressure in this compartment. Hence, with this unit, it is possible to precisely control the suction and to keep the negative pressure stable.

## CVP in MEA-System Set-up

The constant vacuum pump is the perfect addition to your MEA-System if you want to work with perforated microelectrode arrays.

You can establish and most importantly control the suction, so you get a better electrode-to-tissue contact without the need of a weight and your slice is kept in place. Moreover, your experiments are more reproducible as you can produce the exact same suction again.

All you need to do is to equip your MEA-System with a perfusion ground plate, which is available from Multi Channel Systems, and you can get started.

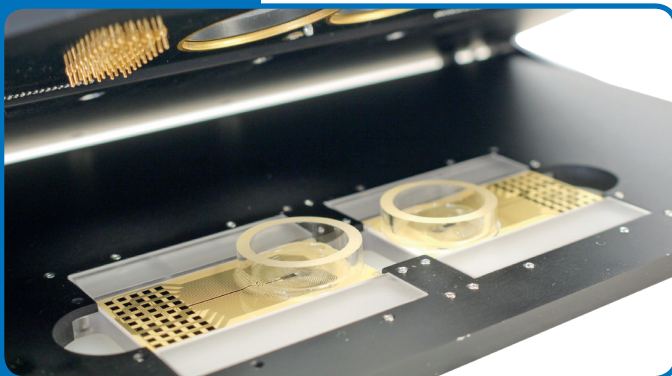
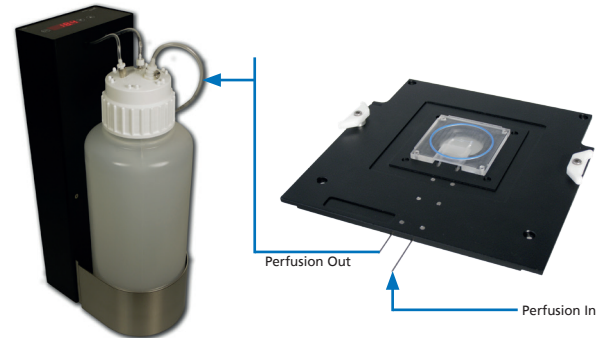

## CVP and MEA2100-32-System

The MEA2100-32-System was designed specifically for acute slice experiments with perforated microelectrode arrays. Through the perforation, you can apply suction with the constant vacuum pump and keep the slice in place. Tubing and a perfusion cannula is already integrated in the system, so you just have to connect the CVP and you can start your experiment.

## Technical specifications

Operating temperature	10 °C to 40 °C
Storage temperature	10 °C to 50 °C
Maximum pressure	-200 mbar below atmospheric pressure
Resolution	+/- 0.1 mbar
Supply voltage	110 V AC or 230 V AC
Dimensions (H x W x D)	0.47 x 0.15 x 0.23 m
Weight	7.4 kg
Sensor type	Differential: Target pressure in relation to actual ambient pressure
Sensor accuracy	+/- 2.5 %
Fuse	1 A M
Capacity of the pp-bottle	5 l

- Made
- in
- Germany

© 2013

Multi Channel Systems MCS GmbH

Product information is subject to change without notice. Products that are referred to in this document may be either trademarks and/or registered trademarks of the respective owners. The publisher and the author make no claim to these trademarks.



Multi Channel Systems  
MCS GmbH

Aspenhaustraße 21  
72770 Reutlingen  
Germany

Fon +49-7121-9 09 25 25  
Fax +49-7121-9 09 25 11

sales@multichannelsystems.com  
www.multichannelsystems.com